

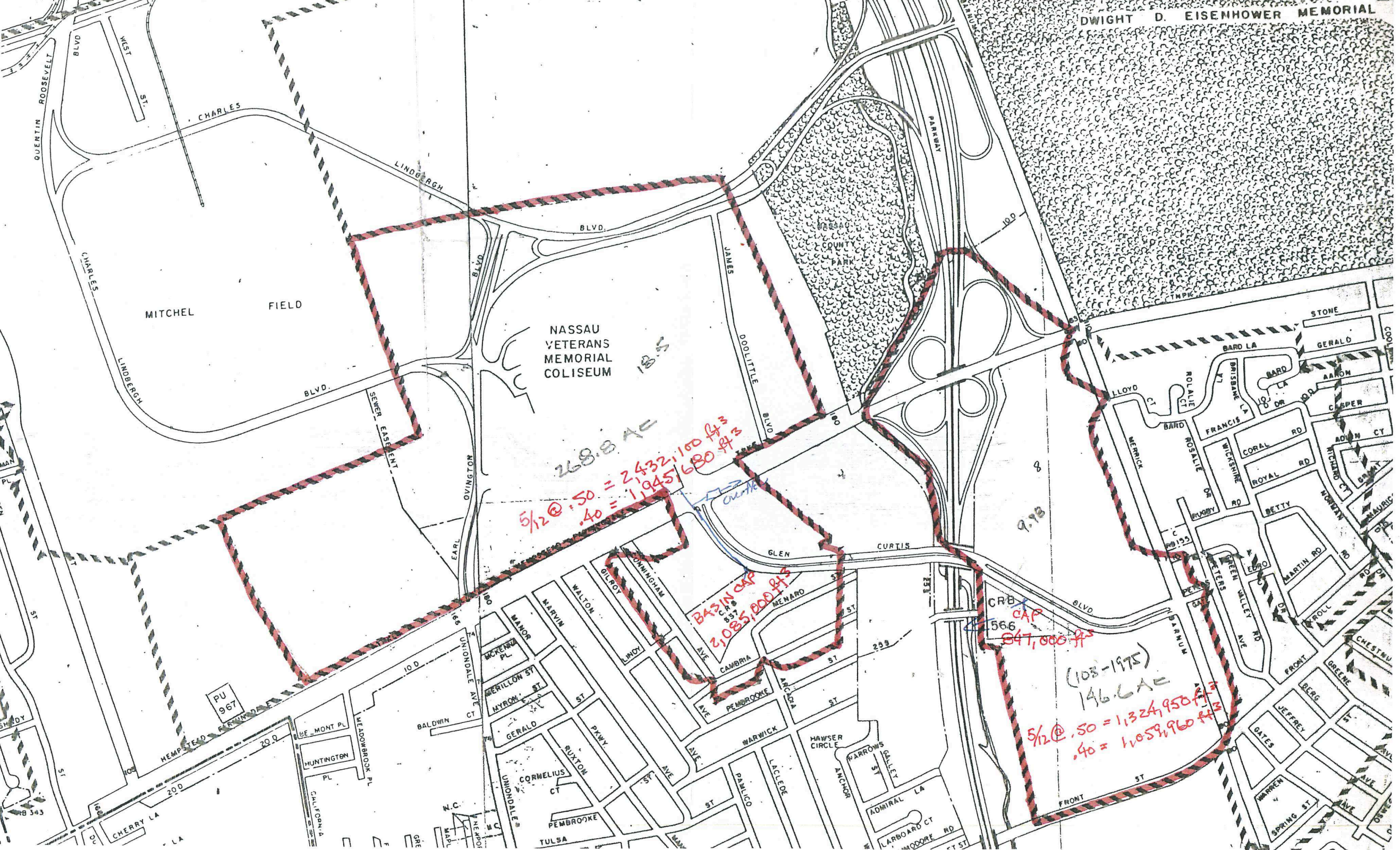

# Appendix 3.2-2

## Existing NCDPW Recharge Basin Tributary Areas and Capacities



268.8 AC

$5/12 @ .50 = 2,432,100 \text{ ft}^3$   
 $.40 = 1,945,680 \text{ ft}^3$

**Basin cap**  
2,085,000 ft<sup>3</sup>

CRB  
566  
847,000 ft<sup>3</sup>

(108-1975)  
146.6 AC  
 $5/12 @ .50 = 1,324,950 \text{ ft}^3$   
 $.40 = 1,059,960 \text{ ft}^3$

PU 967

343