

MENDED APR. 28, 1959
 AUG. 12, 1965
 JAN. 9, 1968
 APR. 19, 1968
 NOV. 10, 1970
 L.P.R.D.-DEC. 9, 1975
 MAY 25, 1976
 APRIL 3, 1979
 OCT. 19, 1982
 OCT. 29, 1984
 OCT. 25, 1988
 JUNE 17, 2003

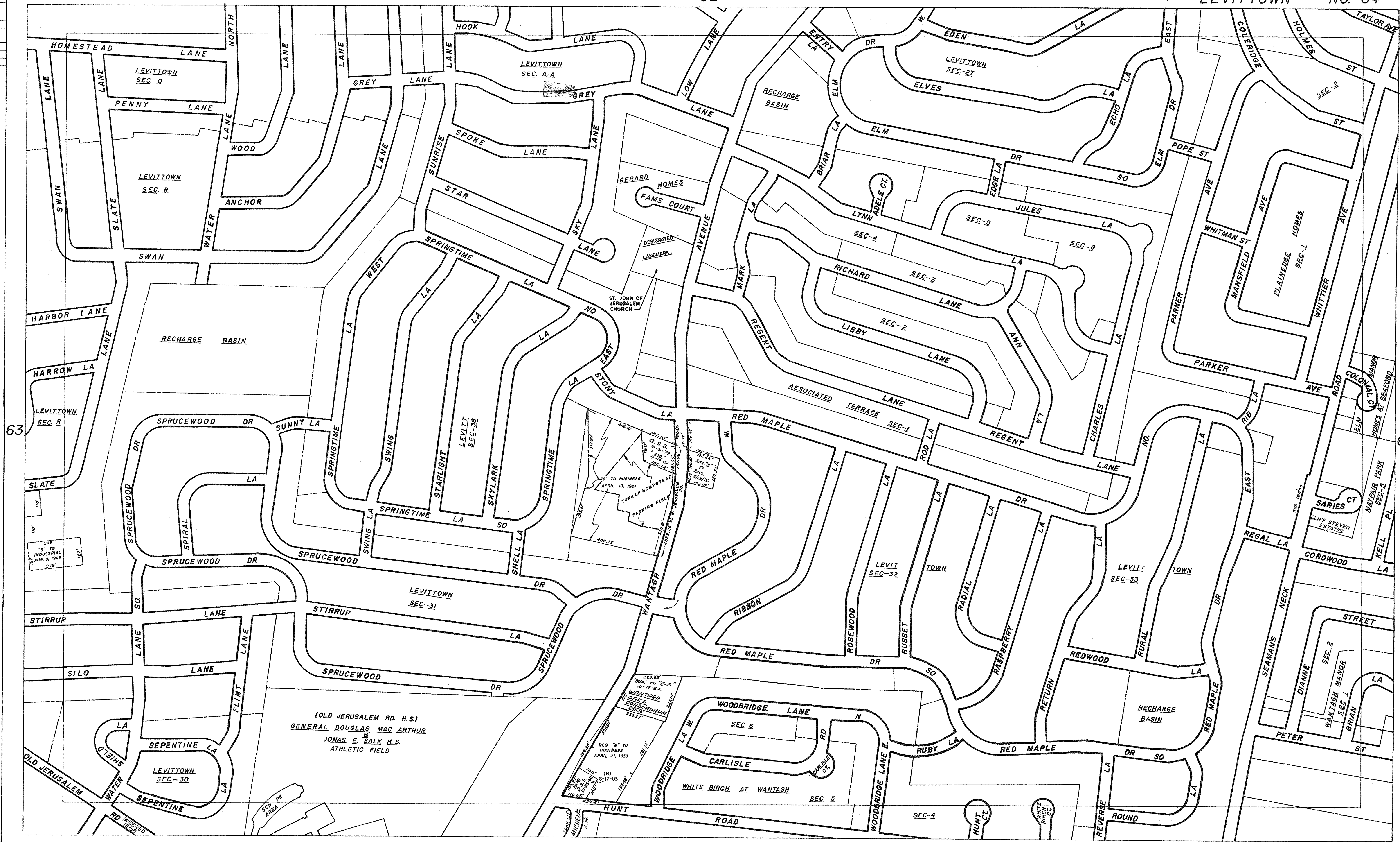

DRAWN BY R.Z.
 CHECKED BY ...

THE OFFICIAL TOWN OF HEMPSTEAD ZONING MAP WAS ESTABLISHED AND ADOPTED IN 1929 BY THE TOWN OF HEMPSTEAD ZONING COMMISSION AND PLANNING BOARD. THIS SHEET MAY NOT ACCURATELY REFLECT HIGHWAY ACQUISITION AND PROPERTY ALIGNMENT AND MAY BE SUBJECT TO ANY STATEMENT OF FACT AN ACCURATE SURVEY MIGHT REVEAL.

THE NOTATION (R) HAS BEEN ADDED TO THE ZONING SHEETS AS OF 10/15/83, TO DENOTE THAT DECLARATION, RESTRICTIONS OR COVENANTS HAVE BEEN MADE PART OF THE ZONING. REZONINGS PRIOR TO THAT DATE ARE NOT SO DESIGNATED AND MAY OR MAY NOT HAVE CONDITIONS OR RESTRICTIONS IMPOSED ON THEIR USE. THE ACTUAL REZONING DOCUMENTS SHOULD BE EXAMINED AT THE TOWN CLERK'S OFFICE TO DETERMINE IF ANY C & R'S ENCOMBER THE USE OF APPLICABLE PROPERTY.