

AMENDED
 6-23-59
 7/17/59
 8/13/59
 2/5/60
 2/23/60
 1/24/61
 6/21/61
 9/21/62
 10/9/62
 1/5/63
 12/3/65
 5/9/67
 8/11/70
 5-18-71
 11/30/71
 1/4/72
 1/25/72
 3/16/72
 11/21/72
 6/4/73
 8/9/73
 8/9/74
 9/15/75
 8/15/76
 1/25/80
 9/30/80
 12/16/80
 12/6/83
 1/14/86
 10/18/88
 7/10/90
 9/11/90
 1/28/92
 9/22/92
 6/14/94
 10/4/94
 8/5/97
 1/28/03
 4/10/12

FRANKLIN SQUARE

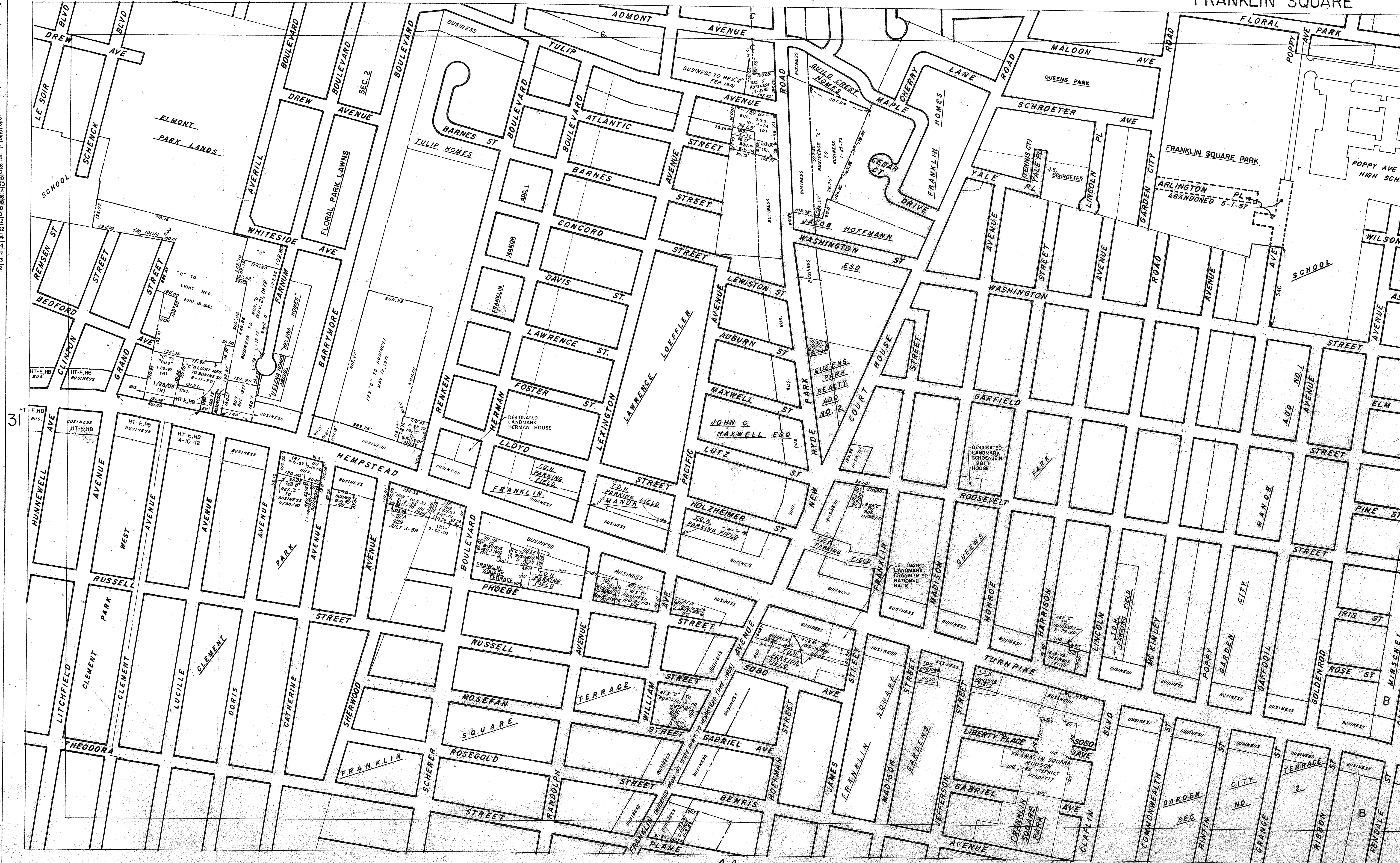

ALL RESIDENCE "C" EXCEPT AS OTHERWISE NOTED PREPARED BY HEMPSTEAD PLANNING

Eddie Hoyes
 REDRAWN BY
 Phil Stozzone
 CHECKED BY
 DATE SEPT. 2002

THE OFFICIAL TOWN OF HEMPSTEAD ZONING MAP WAS ESTABLISHED AND ADOPTED IN 1929 BY THE TOWN OF HEMPSTEAD ZONING COMMISSION AND PLANNING BOARD. THIS SHEET MAY NOT ACCURATELY REFLECT HIGHWAY ACQUISITION AND PROPERTY ALIGNMENT AND MAY BE SUBJECT TO ANY STATEMENT OF FACT AN ACCURATE SURVEY MIGHT REVEAL.

THE NOTATION (R) HAS BEEN ADDED TO THE ZONING SHEETS AS OF 10/15/88, TO DENOTE THAT DECLARATION, RESTRICTIONS OR COVENANTS HAVE BEEN MADE PART OF THE REZONING. REZONINGS PRIOR TO THAT DATE ARE NOT SO DESIGNATED AND MAY OR MAY NOT HAVE CONDITIONS OR RESTRICTIONS IMPOSED ON THEIR USE. THE ACTUAL REZONING DOCUMENTS SHOULD BE EXAMINED AT THE TOWN CLERK'S OFFICE TO DETERMINE IF ANY C & R'S ENCOMBER THE USE OF APPLICABLE PROPERTY.