

AMENDED APRIL 28, 1959

- APRIL 20, 1960
- SEPT. 27, 1960
- OCT. 5, 1960
- SEPT. 5, 1961
- OCT. 23, 1961
- NOV. 16, 1962
- DEC. 28, 1962
- JAN. 6, 1964
- MAY 24, 1965
- JULY 20, 1965
- OCT. 15, 1965
- DEC. 14, 1965
- DEC. 12, 1966
- MARCH 16, 1967
- MAY 5, 1967
- JUNE 14, 1967
- JULY 19, 1967
- JUNE 26, 1968
- OCT. 4, 1968
- APRIL 8, 1969
- VIRGINIA AVE
- APRIL 8, 1969
- MAY 26, 1970
- JULY 6, 1973
- MAR. 30, 1976
- JUNE 28, 1977
- FEB. 24, 1981
- MAY 26, 1981
- APRIL 16, 1985
- MAY 23, 1989
- MAY 23, 1995
- DEC. 21, 1999
- NOV. 14, 2000
- MAY 7, 2002
- AUGUST 13, 2002
- JAN. 28, 2003
- MARCH 25, 2003
- MAY 13, 2003
- JUNE 23, 2003
- SEPT. 9, 2003
- MAY 23, 2006
- SEPT. 19, 2006
- MARCH 6, 2007
- APRIL 29, 2014

152

ISLAND PARK— OCEANSIDE — NO. 165

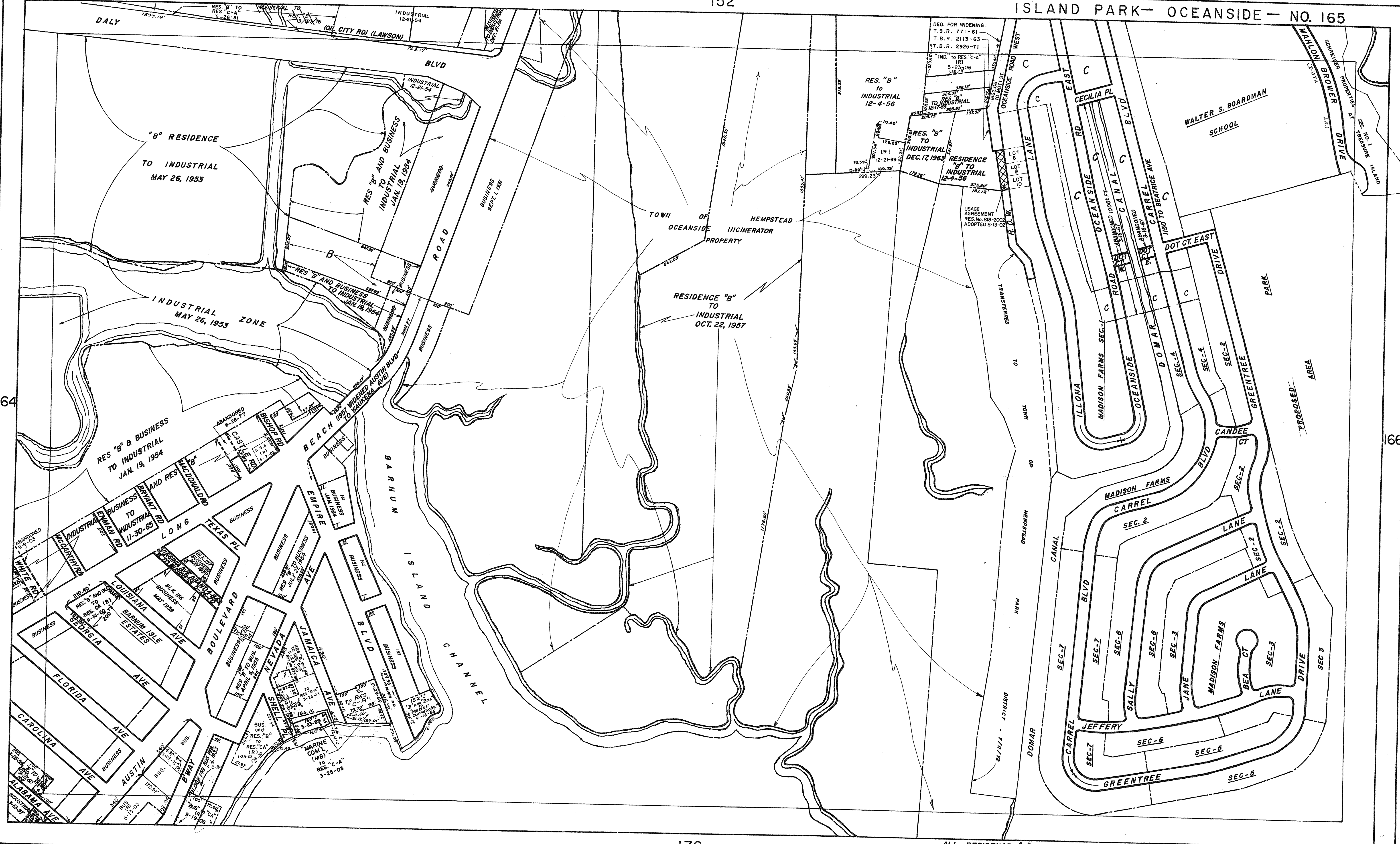

64

66

178

ALL RESIDENCE "B" EXCEPT AS OTHERWISE NOTED

PREPARED BY HEMPSTEAD PLANNING BOARD

DATE: AUGUST 1972
DRAWN BY R.Z.
CHECKED BY R.V.

THE OFFICIAL TOWN OF HEMPSTEAD ZONING MAP WAS ESTABLISHED AND ADOPTED IN 1929 BY THE TOWN OF HEMPSTEAD ZONING COMMISSION AND PLANNING BOARD. THIS SHEET MAY NOT ACCURATELY REFLECT HIGHWAY ACQUISITION AND PROPERTY ALIGNMENT AND MAY BE SUBJECT TO ANY STATEMENT OF FACT AN ACCURATE SURVEY MIGHT REVEAL.

THE NOTATION (R) HAS BEEN ADDED TO THE ZONING SHEETS AS OF 10/15/88, TO DENOTE THAT DECLARATION, RESTRICTIONS OR COVENANTS HAVE BEEN MADE PART OF THE ZONING. REZONINGS PRIOR TO THAT DATE ARE NOT SO DESIGNATED AND MAY OR MAY NOT HAVE CONDITIONS OR RESTRICTIONS IMPOSED ON THEIR USE. THE ACTUAL REZONING DOCUMENTS SHOULD BE EXAMINED AT THE TOWN CLERK'S OFFICE TO DETERMINE IF ANY C & R'S ENCUMBER THE USE OF APPLICABLE PROPERTY.