

APRIL 28, 1959
 AMENDED FEB. 5, 1960
 JUNE 19, 1962
 SEPT. 19, 1962
 SEPT. 27, 1962
 APRIL 12, 1963
 AUGUST 16, 1963
 AUGUST 3, 1967
 SEPT. 25, 1967
 OCT. 24, 1967
 NOV. 26, 1968
 FEB. 25, 1969
 APRIL 7, 1969
 APRIL 29, 1969
 AUGUST 23, 1969
 AUGUST 12, 1980
 FEB. 3, 1981
 DEC. 21, 1984
 FEB. 6, 1990
 FEB. 26, 1991
 OCT. 19, 1993
 APRIL 26, 1994
 DEC. 7, 1997
 DEC. 7, 1999
 DEC. 5, 2000
 AUG. 3, 2010
 MAY 20, 2014
 SEPT. 2, 2014

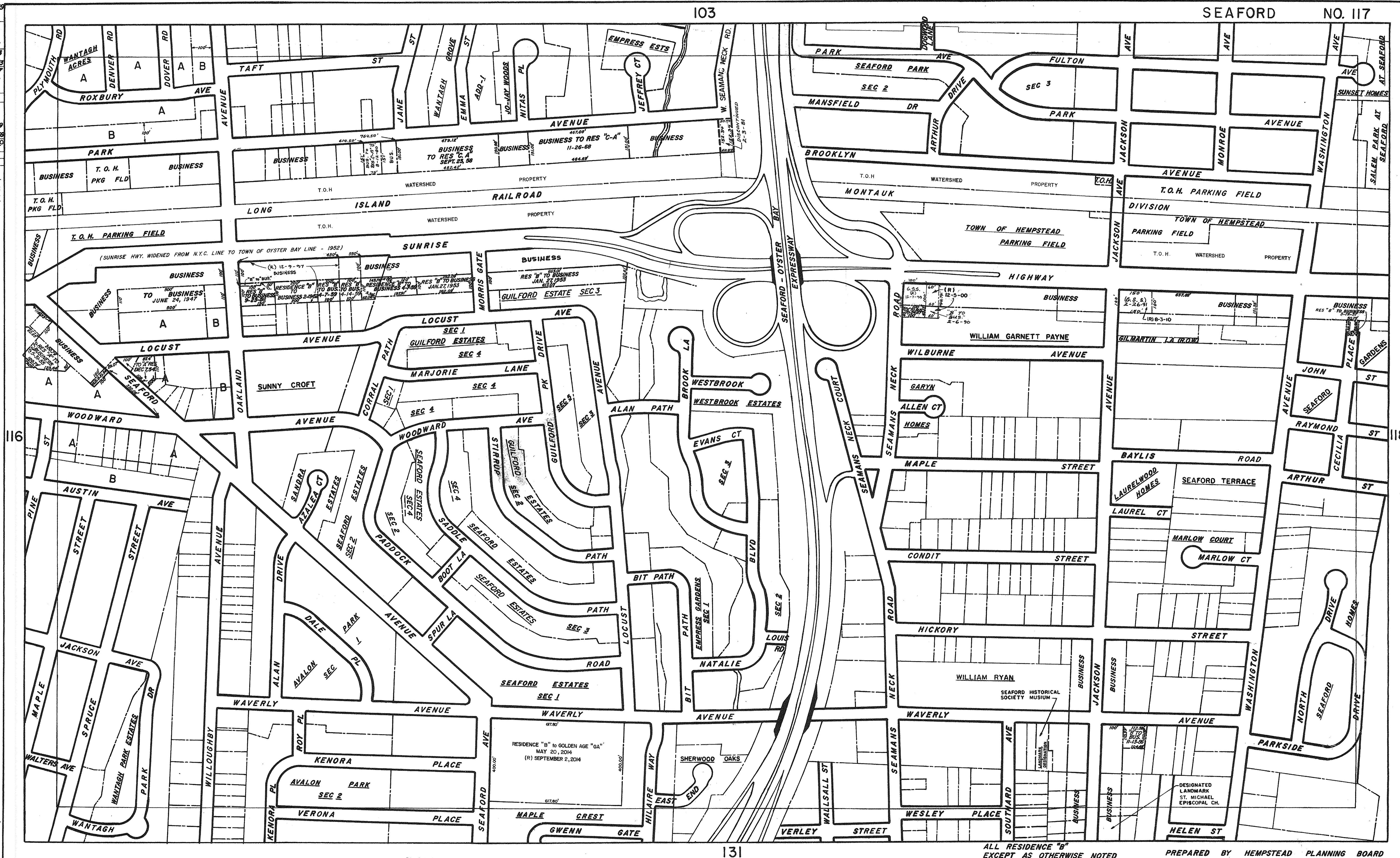

DATE: SEPTEMBER 1972
 DRAWN BY R.Z.
 CHECKED BY R.Y.

THE NOTATION (R) HAS BEEN ADDED TO THE ZONING SHEETS AS OF 10/15/88, TO DENOTE THAT DECLARATION RESTRICTIONS OR COVENANTS HAVE BEEN MADE PART OF THE ZONING. REZONINGS PRIOR TO THAT DATE ARE NOT SO DESIGNATED AND MAY OR MAY NOT HAVE CONDITIONS OR RESTRICTIONS IMPOSED ON THEIR USE. THE ACTUAL REZONING DOCUMENTS SHOULD BE EXAMINED AT THE TOWN CLERK'S OFFICE TO DETERMINE IF ANY C & R'S ENCUMBER THE USE OF APPLICABLE PROPERTY.

THE OFFICIAL TOWN OF HEMPSTEAD ZONING MAP WAS ESTABLISHED AND ADOPTED IN 1929 BY THE TOWN OF HEMPSTEAD ZONING COMMISSION AND PLANNING BOARD. THIS SHEET MAY NOT ACCURATELY REFLECT HIGHWAY ACQUISITION AND PROPERTY ALIGNMENT AND MAY BE SUBJECT TO ANY STATEMENT OF FACT AN ACCURATE SURVEY MIGHT REVEAL.

PREPARED BY HEMPSTEAD PLANNING BOARD